

CIRCULATE TO:

Parts Manager
Sales Manager
Service Manager
Maintenance Mgr

PRODUCT SUPPORT BULLETIN **No.0200**

PRODUCT: TC90 Compactors

November 19, 1997

SUBJECT: Mounting Studs for Hydraulic Drive Motor

EQUIPMENT AFFECTED: 3758-96-?, 3834-97-?, 3853-97-?

CLASSIFICATION: Mandatory Safety
Mandatory Repair (stock units)
Optional Repair
Fix-as-fail (Field units)
Information

SITUATION: There is a possibility that during the assembly of these compactors the mounting studs (1) holding the hydraulic motor (2) to the cover plate (3) may protrude through this plate. If the studs protrude they will not allow the bearing housing (4) and the cover plate mating surfaces to sit flush against one another.

SOLUTION: *Note before removing any nut or bolt from this compactor, they should be moderately heated with a torch to break the bond of the locktite used in the assembly process.* Remove hydraulic drive motor from the mounting plate by removing two nuts (5) and nord-lock-washers (6). The motor has a splined shaft and will pull away from the unit once the two nuts have been removed. Remove the four bolts (7) holding the cover plate and bearing housing to the compactor base (8). Check the cover plate to see if the two studs protrude through and if so, grind flush using a small power grinder. The bearing housings should also be removed on both sides and the bearings (9) checked to insure no unusual wear is taking place. The two shafts on the cam (10) should also be checked. If the bearing does not slide easily, polish the cam shafts with a fine emery cloth. Re-assemble the unit using 271 Locktite on all bolts and nuts. Torque bearing bolts (7) to 120 FT LBS and hydraulic mounting stud nuts (5) to 90 FT LBS. After assembly is complete, lubricate bearings with 8-10 shots of a good quality bearing grease at location 'A' and 'B'.

MATERIALS: 271 Locktite or equivalent
Bearing grease; Shell EP2, Texaco RB2, Mobilux EP2, or equivalent
Fine grade of emery cloth
Set of standard Ox -Acc Torches
Torque Wrench, 0-200 FT LBS

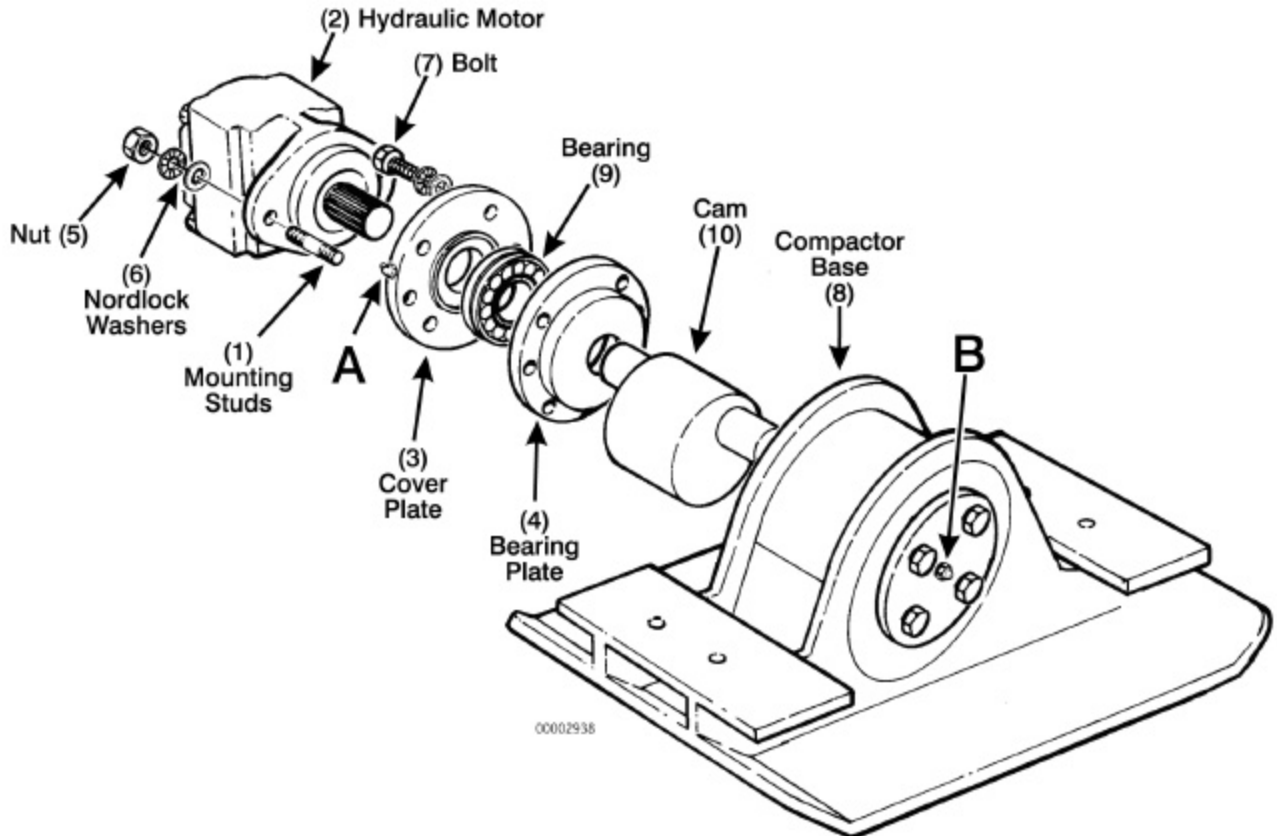

TC90 Compactor