



**BREAKER
TECHNOLOGY,
INC.**

An ASTEC COMPANY

CIRCULATE TO:

Parts Manager

Sales Manager

Service Manager

SERVICE BULLETIN

No.207

PRODUCT: PVG120 Control Valves

Date: November 23, 1999

SUBJECT: Converting PVG120 Control Valves
from open to closed center inlets and from closed to open center inlets

EQUIPMENT AFFECTED: Control valve bodies, s/n 155G5023, 5022, 5037 and
5038 SAE version without uprating.

CLASSIFICATION: Information

SITUATION: When replacing hydraulic system gear pump with a piston pump (open to closed) or,
When replacing hydraulic system piston pump with a gear pump (closed to open).

Converting Open Center to Closed

*Applicable on s/n: 155G5022 to 155G5023 &
155G5038 to 155G5037*

1. Remove plugs (item 1 & 2).
2. Remove plug (item 3), then remove orifice (item 4), now switch the two and install the orifice into spool (item 5), and install plug (item 3) where the orifice was removed.
3. Reinstall plugs (item 1 & 2), conversion is complete.

*Applicable on s/n: 155G5028 to 155G5022 &
155G5029 to 155G5038*

1. Remove plugs (item 1 & 2).
2. Remove spool (item 5) and install new compensator spool, part no.155G5312. Replace springs (items 6 & 7) with part no.s 155G5331 and 155G5330.
3. Reinstall plug (item 1).
4. Remove orifice (item 4) and replace with new plug, part no. 681X3019.
5. Reinstall plug (item 2), conversion is complete.

Converting Closed Center to Open

*Valve body s/n; 155G5023 to 155G5022 and
155G5037 to 155G5038*

1. Remove plugs (item 1 & 2).
2. Remove orifice (item 3), then remove plug (item 4), now switch the two and install the plug into spool (item 5), and install the orifice where there plug was removed.
3. Reinstall plugs (item 1 & 2), conversion is complete.

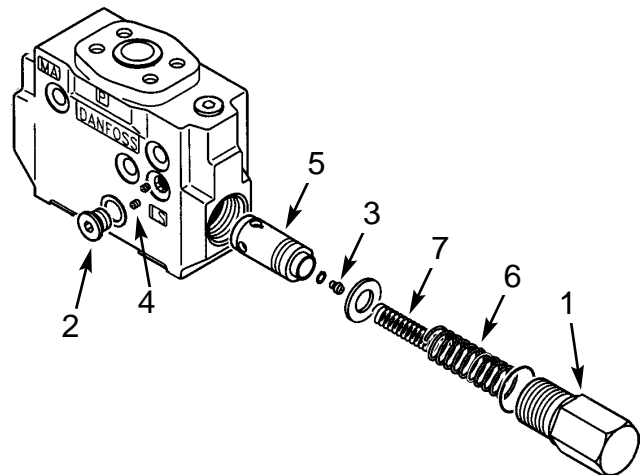

This product bulletin advises you of a product improvement/maintenance suggestion and does not imply that its contents are subject to a campaign program



PRODUCT SUPPORT BULLETIN

No.207

PRODUCT: PVG32 Control Valves

SUBJECT: Converting PVG32 Control Valves
from open to closed center inlets and from closed to open center inlets

EQUIPMENT AFFECTED:

CLASSIFICATION: Information

SITUATION: When replacing hydraulic system gear pump with a piston pump (open to closed) or,
When replacing hydraulic system piston pump with a gear pump (closed to open).

Converting Open Center to Closed

1. Remove plug (item 1).
2. Remove plug (item 5)
3. Install orifice (item 4), and plug (item 2) and seal (item 3).
4. Reinstall plug (item 1), conversion is complete.

Parts Required (to convert to Closed Center)

Item	Description	Part No.
2	Plug	681X1506
3	Seal	633B9008
4	Orifice	155L5389

Converting Closed Center to Open

1. Remove plug (item 1), identified LS (load sensing port).
2. Remove plug (item 2) and seal (item 3) and orifice (item 4).
3. Install plug (item 5).
4. Reinstall plug (item 1), conversion is complete.

Parts Required (to convert to Open Center)

Item	Description	Part No.
5	Plug	155L5153

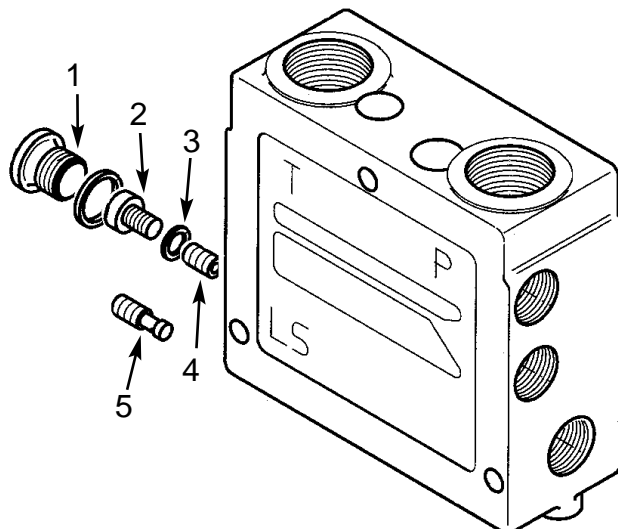

This product bulletin advises you of a product improvement/maintenance suggestion and does not imply that its contents are subject to a campaign program